

# SCAR

## JUNE 7 - 10, 2003

### HYNES CONVENTION CENTER

#### BOSTON, MA

#### LEVEL 1, HALL A

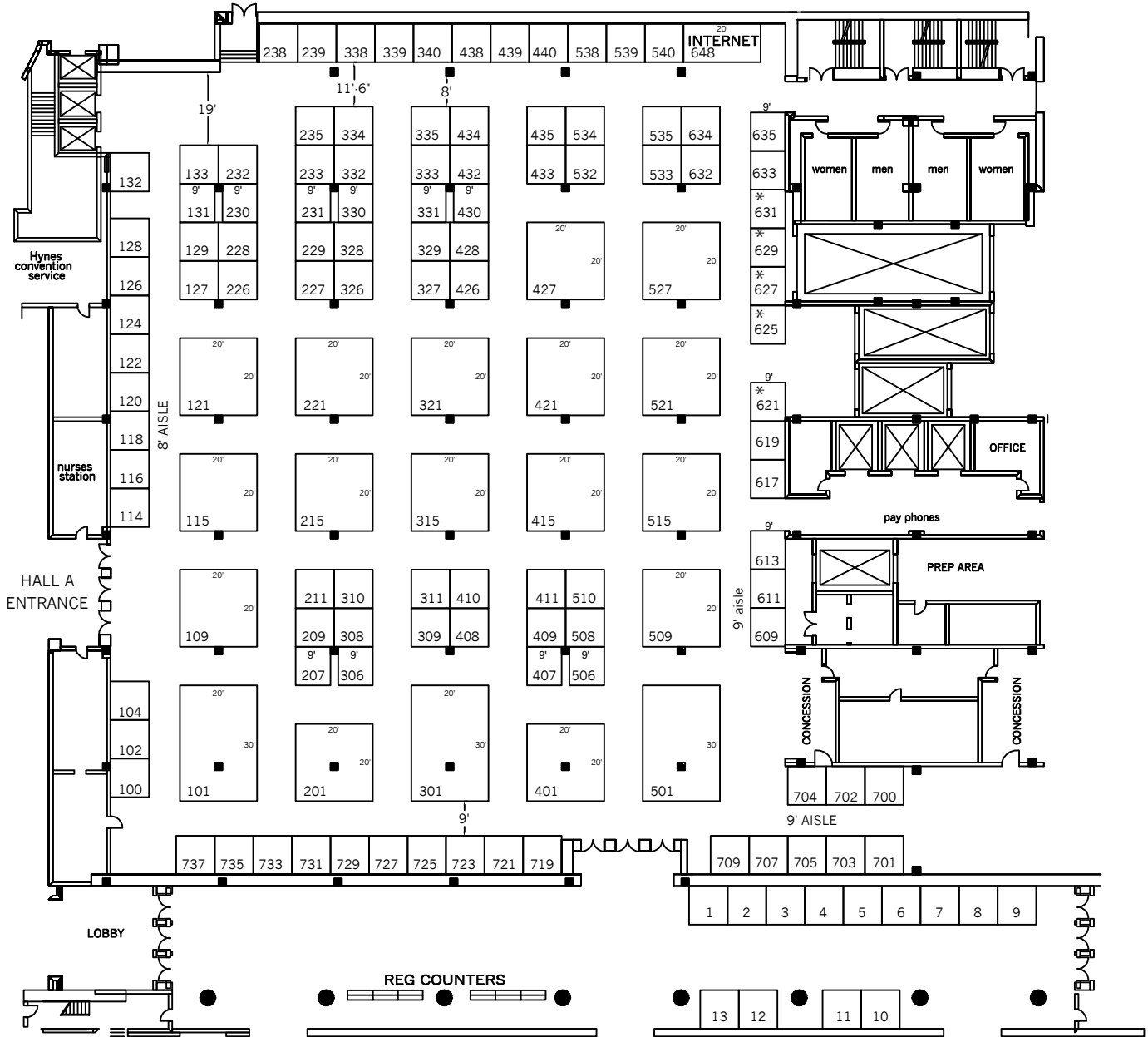

**BOOTH TOTAL:**  
 9'X10' - 22  
 10'X10' - 93  
 20'X20' - 16  
 20'X30' - 3

AISLES ARE 10' UNLESS NOTED  
 BOOTHS ARE 10' X 10' UNLESS NOTED

\* - LAST IN/FIRST OUT

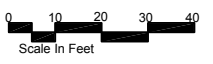

**Facility Notes:**  
 fch - FIRE HOSE CABINET (MUST BE KEPT CLEAR)  
 ■ - typical column, 24" x 24"  
 electric & telephone available at columns  
 △ - utility floor box: water, drain, air  
 □ - electric & telephone: 120/208v, 100 amp  
 Registration & Lobby area ceiling height is 16'  
 Ceiling height of Hall A & B is 14',  
 except shading area at the back of both halls is 11'



AE: Cheryl Field	Rev. : 8-5-02	# 5
File Name: SCAR-03-#1	By: Theresa Tsui	